



# 130 MONITOR STREET

## JERSEY CITY, NJ 07304

**HIGHLIGHTS:**

- 140 units located in the heart of Bergen-Lafayette steps from Liberty State Park and the Hudson-Bergen Light Rail.
- Surrounded by hundreds of new residential units with hundreds more under construction in the immediate area.
- Brand new daycare space at the base of the project located next to the main lobby.



Under Construction - June 2025 Completion

**SPACE AVAILABLE:**

- Ground Floor**
- 5,197 SF

**CEILING HEIGHT:**

- Ground Floor**
- 15 FT

**DELIVERY:**

- Daycare Space/  
Vanilla Box

**BUILD-OUT:**

- 5 Classrooms
- 1 Playroom
- 1 Kitchen/Breakroom
- Kids Bathrooms
- Reception Area

**ASKING RENT:**

- Upon Request

**NEIGHBORING RETAIL:**



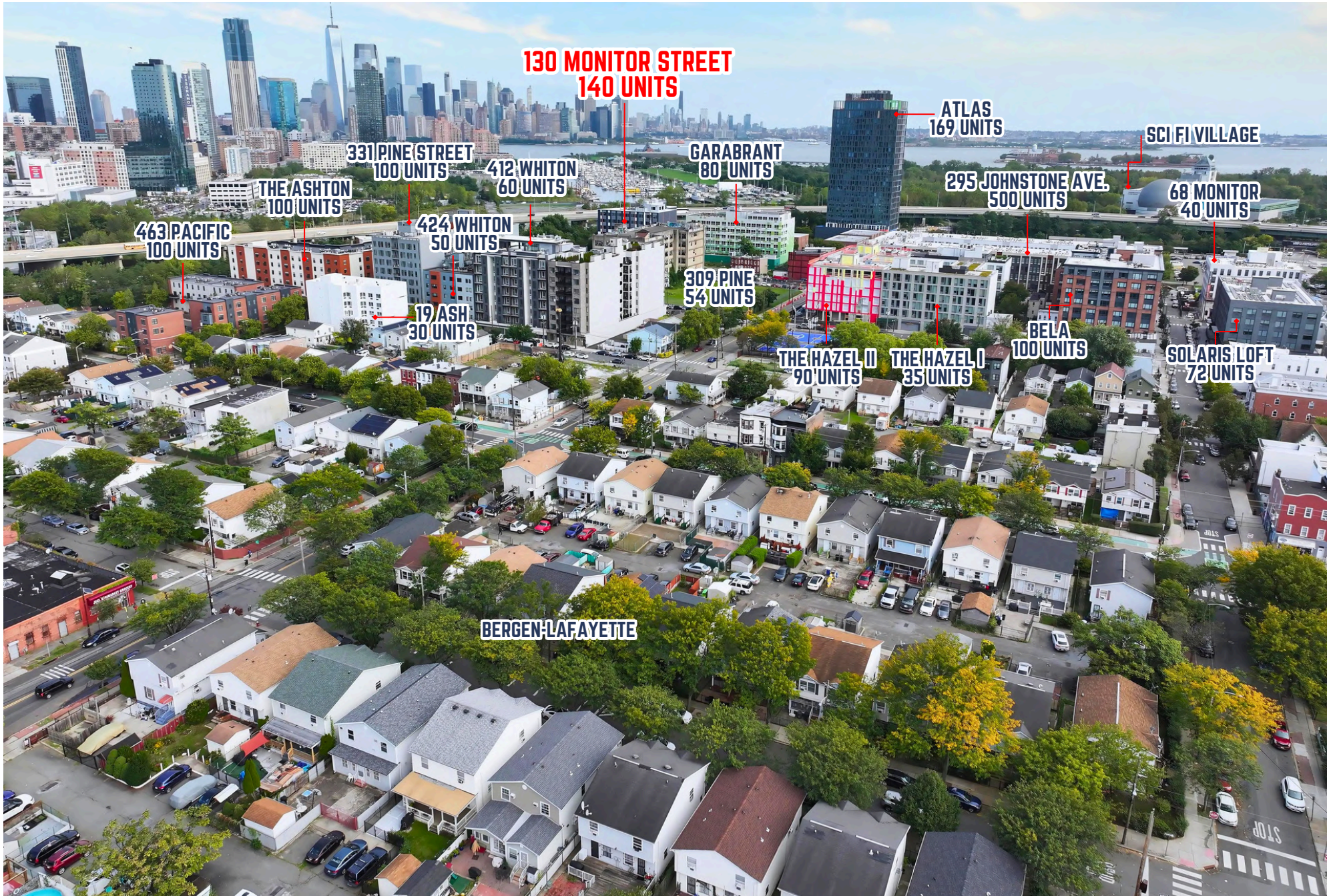

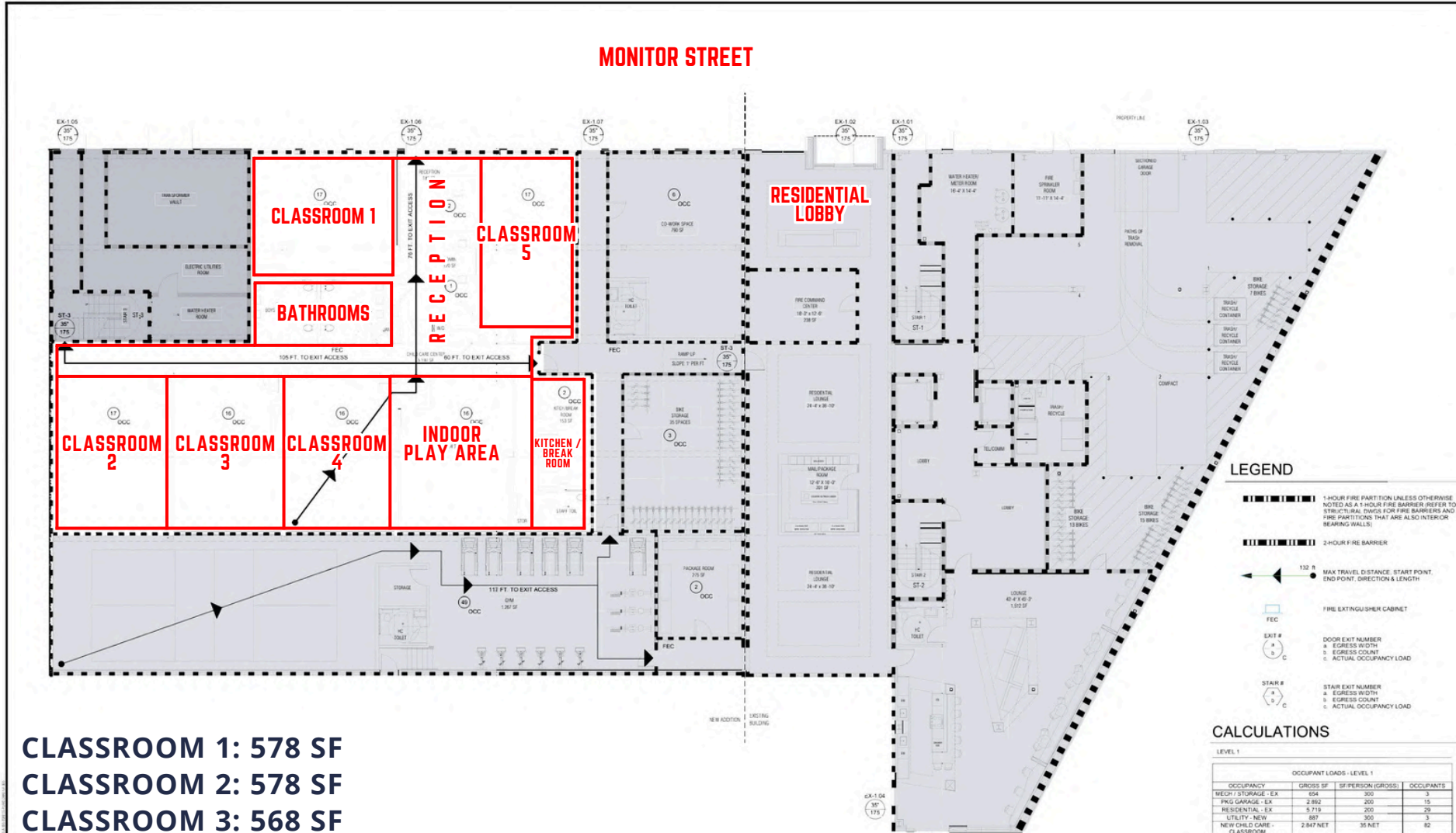

**CLASSROOM 1: 578 SF**  
**CLASSROOM 2: 578 SF**  
**CLASSROOM 3: 568 SF**  
**CLASSROOM 4: 566 SF**  
**CLASSROOM 5: 541 SF**  
**INDOOR PLAY SPACE: 534 SF. (CAN BE CONVERTED INTO CLASSROOM)**  
**KITCHEN / BREAK ROOM: 153 SF**

Palermo | Edwards  
Architecture

880 Mountain Rd  
Kinnelon, NJ 07051  
201.532.4413 ext  
913.809.1723 fax

jenpalermo@palermoedwards.com  
 JENNIFER L. PALERMO, RA, NJ, AIA, LEED AP  
 NO. 239948  
 PA. 2004712  
 GA. 131762

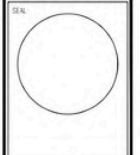

THIS DOCUMENT IS THE EXCLUSIVE PROPERTY OF PALERMO EDWARDS ARCHITECTURE. NO DOCUMENT AND NO PORTION THEREOF SHALL BE REPRODUCED OR USED FOR OTHER THAN THE SPECIFIC PROJECT FOR WHICH IT WAS PREPARED WITHOUT THE WRITTEN CONSENT OF PALERMO EDWARDS ARCHITECTURE.

CONTRACT NO.

118-130  
MONITOR  
STREET

Morris  
Redevelopment  
TOD NORTH  
JERSEY CITY, NJ  
HUDSON COUNTY

New 8-Story,  
70-Unit  
Addition

FOR:  
LOF III, LLC  
P.O. Box 4  
Jersey City, NJ

SUBMISSIONS:  
 BD SET 08/01/2023  
 PERMIT SET 12/12/2023

REVISIONS:

NO.	REVISION DESCRIPTION	DATE

DRAWN BY: JF  
 CHECK BY: ME  
 PROJECT NO: 2203

SHEET TITLE:  
FIRST FLOOR  
EGRESS PLAN

SHEET NO:  
A-005

**LEGEND**

- 1-HOUR FIRE PARTITION UNLESS OTHERWISE NOTED AS A 1-HOUR FIRE BARRIER. REFER TO STRUCTURAL DWGS FOR FIRE BARRIERS AND FIRE PARTITIONS THAT ARE ALSO INTERIOR BEARING WALLS.
- 2-HOUR FIRE BARRIER
- 112 # MAX TRAVEL DISTANCE START POINT, END POINT, DIRECTION & LENGTH
- FIRE EXTINGUISHER CABINET
- EXIT #  
a. EGRESS WIDTH  
b. EGRESS COUNT  
c. ACTUAL OCCUPANCY LOAD
- STAIR #  
a. EGRESS WIDTH  
b. EGRESS COUNT  
c. ACTUAL OCCUPANCY LOAD

**CALCULATIONS**

LEVEL 1

OCCUPANCY	GROSS SF	SF/PERSON (GROSS)	OCCUPANTS
MEDIA STORAGE - EX	854	300	3
PKG GARAGE - EX	2,882	200	15
RESIDENTIAL - EX	5,719	200	29
UTILITY - NEW	887	300	3
NEW CHILD CARE - CLASSROOM	2,347 NET	35 NET	67
NEW CHILD CARE - ADMIN	2,350	150	16
NEW CO-WORK	750	150	5
NEW RESIDENTIAL - GYM	2,485	50	49
GRAND TOTAL	18,624		203

EXIT DOOR	DOOR WIDTH	INPERSON	OCCUPANTS
EX-1.01	30"	0.2	125
EX-1.02	30"	0.2	175
EX-1.03	30"	0.2	175
EX-1.04	30"	0.2	175
EX-1.05	30"	0.2	175
EX-1.06	30"	0.2	175
EX-1.07	30"	0.2	175
GRAND TOTAL			1,225

**NOTES**

OVERALL DIAGONAL DIMENSION OF BUILDING AT GROUND FLOOR 258'-4"

REQUIRED REMOTEENESS OF EXITS 80'-0"

DISTANCE BETWEEN EXITS 120'-0"

# AREA DEMOGRAPHICS

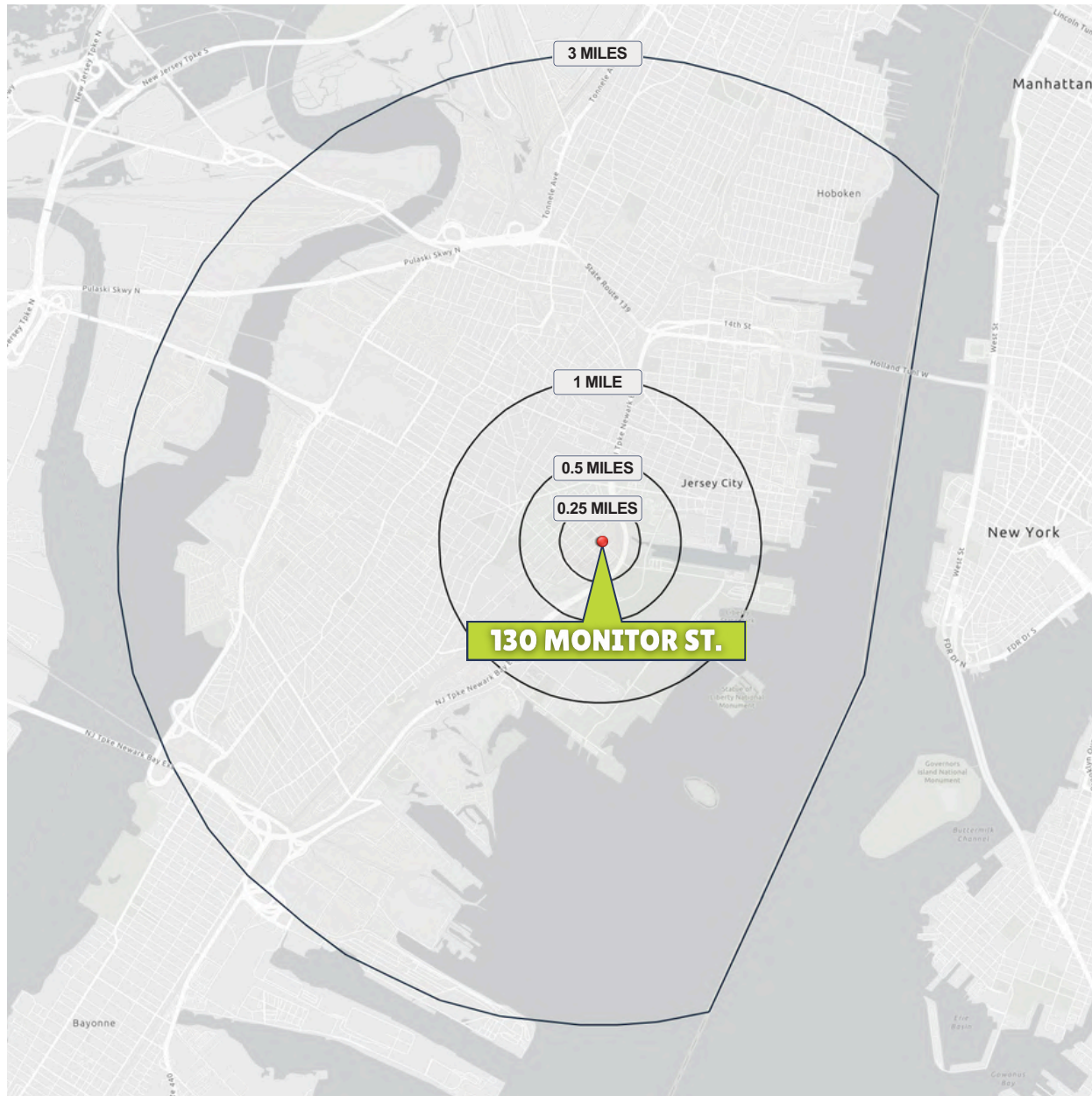

**130 MONITOR ST.**

## .25 MILE RADIUS

### POPULATION

4,370

### HOUSEHOLDS

1,944

### MEDIAN AGE

33.7

### COLLEGE GRADUATES (Bachelor's +)

50.8%

### TOTAL BUSINESSES

51

### TOTAL EMPLOYEES

1,023

### AVERAGE HOUSEHOLD

INCOME

\$87,433

## .5 MILE RADIUS

### POPULATION

9,161

### HOUSEHOLDS

3,841

### MEDIAN AGE

34.0

### COLLEGE GRADUATES (Bachelor's +)

39.1%

### TOTAL BUSINESSES

213

### TOTAL EMPLOYEES

6,553

### AVERAGE HOUSEHOLD INCOME

\$77,071

## 1 MILE RADIUS

### POPULATION

59,892

### HOUSEHOLDS

27,514

### MEDIAN AGE

36.3

### COLLEGE GRADUATES (Bachelor's +)

63.7%

### TOTAL BUSINESSES

1,463

### TOTAL EMPLOYEES

31,424

### AVERAGE HOUSEHOLD INCOME

\$154,327

## 3 MILE RADIUS

### POPULATION

359,200

### HOUSEHOLDS

151,052

### MEDIAN AGE

35.7

### COLLEGE GRADUATES (Bachelor's +)

58.3%

### TOTAL BUSINESSES

8,713

### TOTAL EMPLOYEES

171,994

### AVERAGE HOUSEHOLD INCOME

\$149,218

\*2023 estimates