

# J<sup>2</sup> JOURNALSQUARED

**KRE**  
Kusheer Real Estate Group

**National**  
REAL ESTATE ADVISORS



## UNBELIEVABLE RETAIL OPPORTUNITY

**JOURNAL SQUARED  
TOWER III**  
605 Pavonia Ave, Jersey City

- Centre Pompidou Museum (2 Blocks)



- Frank Guarini Justice Center (2 Blocks)



- URBY (1 Block)



- Loew's Theatre (1 Block)

JOIN:

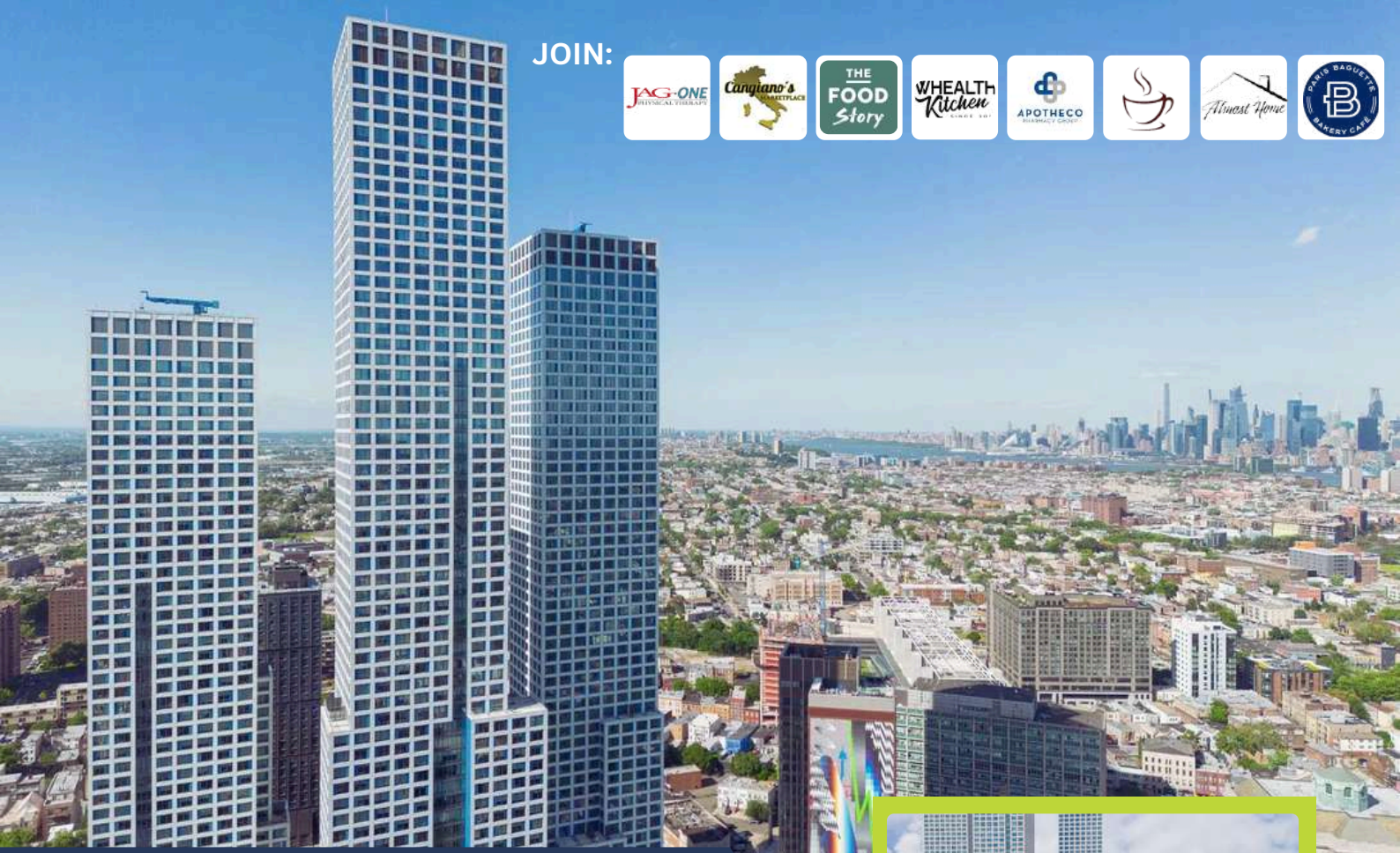

# JOURNAL SQUARED

605 Pavonia Ave, Jersey City, NJ



Completed

## HIGHLIGHTS:

- 835 SF of ground floor retail located at the base of Journal Squared Tower III, a 60 story residential tower located directly above the vibrant Journal Square PATH.
- The third and final tower of this 3 phase development will be wrapping up construction in Mid 2024 with a completed total of 1,870 residential units.
- The 835 SF space fronts on Pavonia and Summit Ave, the absolute best corner in Journal Square. The space is located across from the Hudson County Superior Court House and 2 new 20 story towers along with the new 3 Acre Journal Square Park.

## LOCATION:

- Located directly above the Journal Square PATH.
- Positioned at the core of the Journal Square Central Business District.
- Directly across from the Hudson County Superior Court House and the Magnolia St. PATH Station Entrance.

## SPACE AVAILABLE:

- Retail B Space: 835 SF  
Located on Summit Avenue

## FRONTAGE:

- 100 FT

## CEILING HEIGHT:

- 20 FT

## TERM:

- Negotiable

## LEASE TYPE:

- NNN

## ASKING RENT:

- Upon Request

## NEIGHBORING RETAILERS:



October 2024



2021



2017



# FLOOR PLAN LAYOUT



PROJECT: JOURNAL SQUARED PHASE 3  
 100 PAVONIA AVENUE  
 PHASE 3  
 100 PAVONIA AVENUE  
 PHASE 3

DATE: 08/14/2024  
 DRAWN BY: [Name]  
 CHECKED BY: [Name]  
 SCALE: 1/8" = 1'-0"

PHASE 3  
 FULL BUILD OUT  
 GROUND FLOOR  
 PLAN  
 A3-004

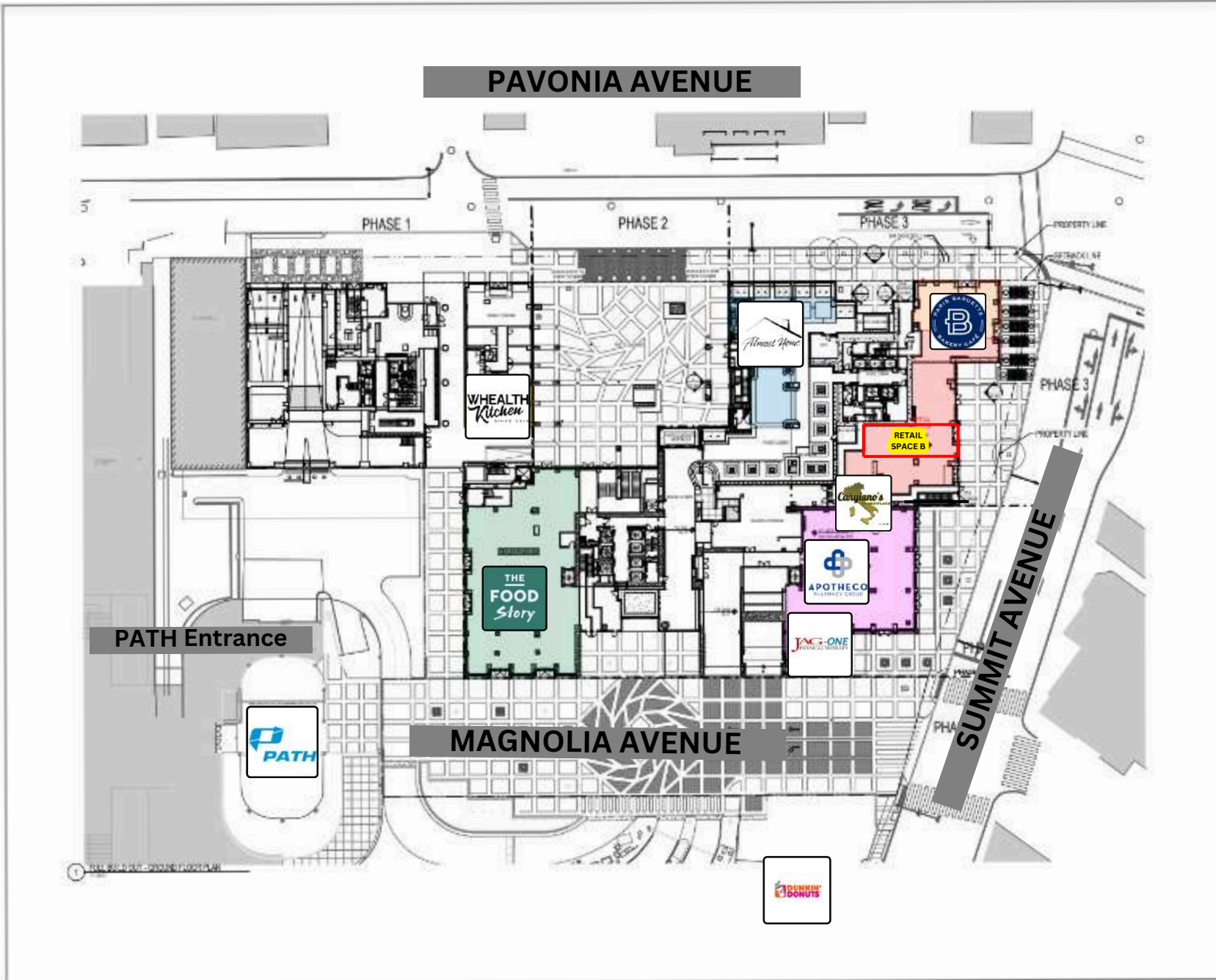

# AERIAL

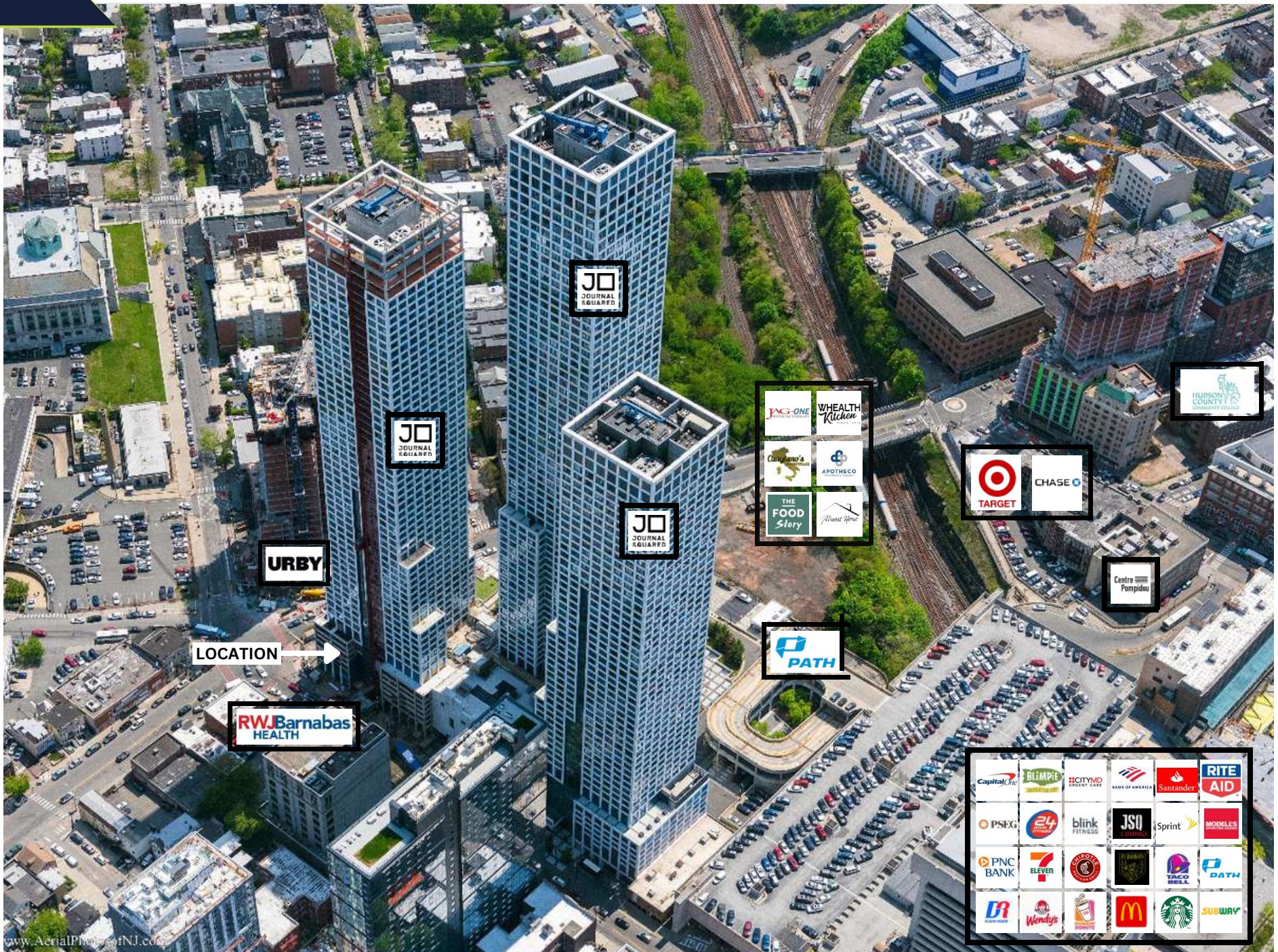

www.AerialPhotoofNJ.com

# NEIGHBORING DEVELOPMENTS

